

Assembling dimensions of cabinet

Drilling hole size on
drawer front

Drawer back

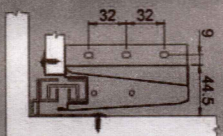
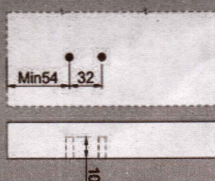
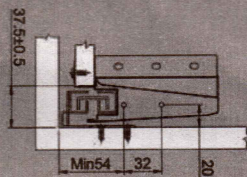

Assembling dimensions of cabinet

Drilling hole size on
drawer front

Drawer back

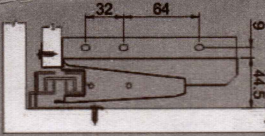
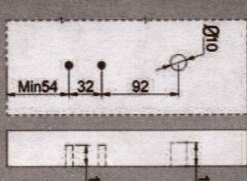
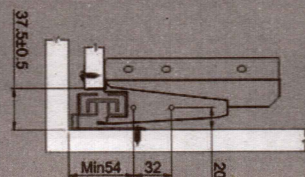

Assembling dimensions of cabinet

Drilling hole size on
drawer front

Drawer back

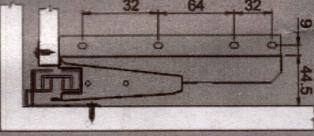
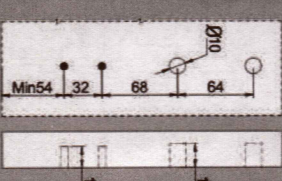
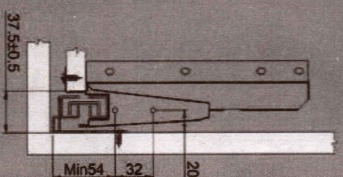

16mm Thickness panel
LW: Internal cabinet width

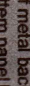
- 
- 1 Back panel height (Refer to *)
Back panel length=LW-89±0.5
- 2 Bottom panel width=LW-75±0.5
Bottom panel length=Nominal length-5mm
- (* If metal back is used:
Bottom panel length=Nominal length-8mm)

- 3 Long tube=LW-71±0.5

- 4 Aluminium front length = $LW - 8 / 10.5$

Item No.	A/B-86	A/B-120	A/B-140	A/B-164	A/B-200
Back panel height	70	104	124	148	188

(Wooden drawer)

Broken line is cabinet

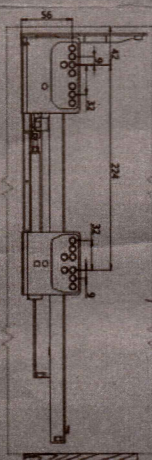

(Inner drawer)

Nominal length: 270/300/350/400/450/500/550 mm

Install wooden drawer front

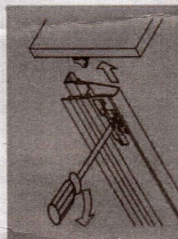
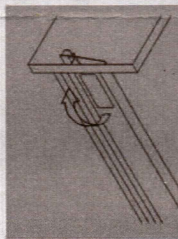
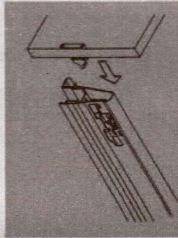
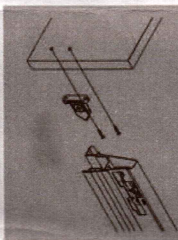

Disassemble wooden drawer front

Wooden drawer front height adjustment: $\pm 2\text{mm}$

Drawer front right
adjustment 1mm

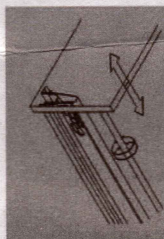
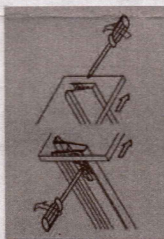
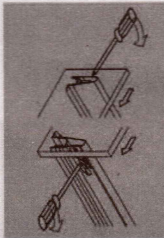
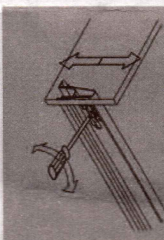

Drawer front left
adjustment 1mm

Gradient adjustment

1. Sliding out the slides

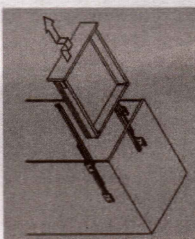
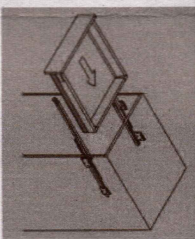
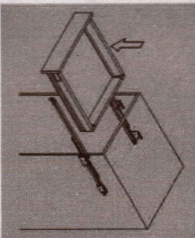
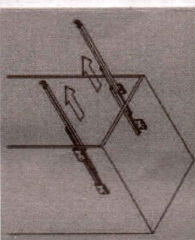

3. Method II: put the drawer from

4. Lift the drawer up for dismantle